

Service Manual

Deep Freezer-upright

DW-25L92•DW-40L92•DW-40L188•DW-25L300•DW-40L262



Effective models

This service manual is effective for following models

Model name	Product code	Voltage(V)	Frequency(Hz)	Plug-type
DW-25L92	BE02M9E0N	220-240	50	English Standard 英式三扁(flat)
DW-40L92	BE02M8E0N	220-240	50	EU Standard 欧式两圆一孔
	BE02M7E0N			English Standard 英式三扁(flat)
DW-40L188	BE02P1E1T	220-240	50	EU Standard 欧式两圆一孔
	BE02P2E1T			English Standard 英式三扁(flat)
DW-25L300	BE02QDE0N	220-240	50	English Standard 英式三圆(round)
DW-40L262	BE02Q4E1T	220-240	50	EU Standard 欧式两圆一孔
	BE02Q3E1T			English Standard 英式三扁(flat)
	BE02Q5E1T			English Standard 英式三圆(round)
	BE02QBE0N	50/60	50/60	English Standard 英式三扁(flat)
	BE02Q0E0A			America Standard 美式
	BE02QCE0N	115	60	America Standard 美式

Content

【Designation】	4
【Safe Caution】	5
【Product appearance】	6
【Product Specifications】	10
【Components and Function Modules】	12
【Disassemble Steps】	14
【Disassemble Steps】	14
【Screen Control System】	16
【Control System Principle】	18
【System Schematic Diagram】	19
【System Circuit Diagram】	20
【Inspection and Maintenance Process for Typical Error】	21
【FAQ&A】	22
【Cooling unit parts】	23
【product nameplate】	24
【Refrigerant perfusion Details】	26
【Troubleshooting】	27
【How to deal with poor cooling】	26
【Used Spare Parts Photo Gallery】	27
【Testing Date】	28

【Designation】

Regulations for type naming:

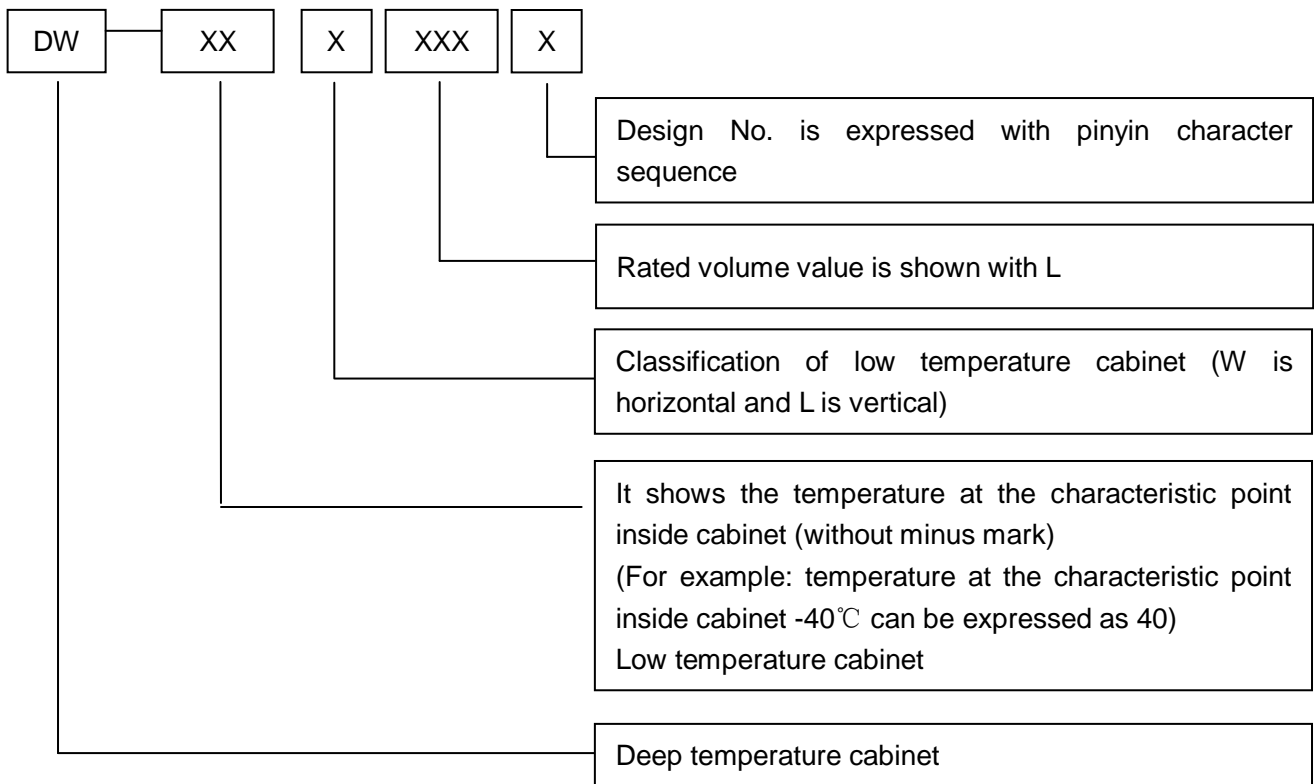

Note: rated volume can be the gross volume or effective volume; the manufacturer can decide it by him according to the actual situation. The effective volume value must be marked on the nameplate whether effective volume or gross volume is marked in the product name.

Examples:

DW-40L262 means that the Deep temperature storage refrigerator with the temperature at characteristic temperature -40°C, horizontal and rated effective volume 262L.

【Safe Caution】

1. If the voltage used is 10% higher or lower than rated voltage, an auto stabilizer above 1000W shall be equipped. Power line that required for lengthening shall be with a cross section no less than 1mm.
2. An independent private jack shall be used and reliably connected. The power line for refrigerator is equipped with three-wire, grounding-type plug which meets standard three-wire, grounding-type receptacle. In no circumstance should the third plug foot (grounding) of the power line be cut or removed. The plug shall be touchable after installation of refrigerator. Power line or plug with abrasion shall not be used. Abraded or damaged power line shall be sent to maintenance point designated by the manufacturer or be replaced by qualified personnel.
3. Hazardous articles of inflammable, explosive, materials such as acid and alkali with strong corrosion are prohibited in the refrigerator.
4. Please don't use flammable spray closely to avoid fire.
5. When there is inflammable gas such as coal gas leakage:
 - Shut the valve for leakage;
 - Open the door and window for ventilation;
 - Don't pull out or insert power plug of the refrigerator.
6. Prevent children playing in the refrigerator to avoid accident.
7. Once the power of the refrigerator is cut, it shall be re-connected at least five minutes later to avoid damage on compressor or the system. The power shall be cut for maintenance. Do not roll or damage the power line.
8. Please wear protective equipments during accessing to the refrigerator to avoid freezing injury. When the refrigerator is scrapped, please remove the doorman. The scrapped refrigerator shall be away from fire and be sent to appointed site for disposition.

【Product appearance】







【 Dimensions 】

DW-25 L92/ DW-40L92

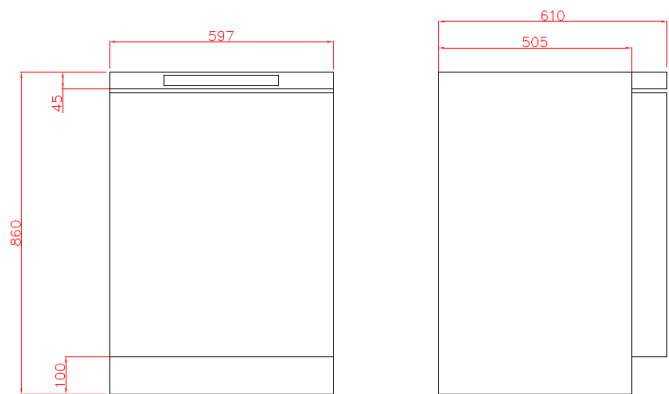

DW-40L188

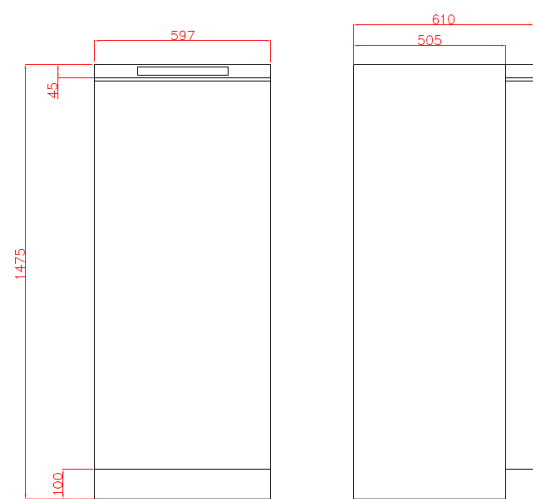

DW-25L300/DW-40L262

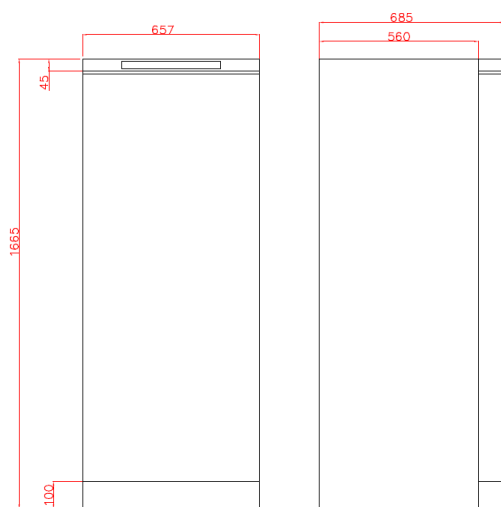

【Product Specifications】

Name	Deep Freezer	
Model	DW-25L92	DW-40L92
External dimensions (W X D X H) (mm)	597×610×860	
Internal dimensions (W X D X H) (mm)	465×440×645	
Effective volume	92L	
Door	Foaming door	
Foam material	Hard polyurethane foam (fluorine-free)	
Compressor	Totally enclosed compressor	
Drawer	3	
Refrigeration	Direct cooling	
Outer plate / inner plate	Spraying steel plate / PS plate	
Condenser / evaporator	Fiber tube / plate type	
Temperature controller	Computer control system	
Refrigerant	R600a 52g	R404a 150g
Weight	46kg	46kg
Temperature range	-10℃~-25℃	-10℃~-40℃
Rated power supply	220-240V~/50Hz	220-240V~/50Hz
Rated power / current	77W/0.35A	220W/2.1A
Noise Level	27dB(A)	40dB(A)
Foaming Agent	CP/IP	
Climate Type	4	
Electrical protection type	I	
Power supply connection	Y	
Testing hole	/	
Alarm	High/low temperature alarm, sensor fault alarm	

Note: Climate Type 4 means the temperature is +30℃, the relative humidity is 55%.

Technical information may vary from the appliance that you have just purchased due to technical improvements.

Name	Deep Freezer			
Model	DW-25L262	DW-25L300	DW-40L262	
External dimensions (W X D X H) (mm)	657×685×1665			
Internal dimensions (W X D X H) (mm)	480×465×1430			
Effective volume	262L	300L	262L	
Door	Foaming door			
Foam material	Hard polyurethane foam (fluorine-free)			
Compressor	Totally enclosed compressor			
Drawer	7			
Refrigeration	Direct cooling			
Outer plate / inner plate	Spraying steel plate / PS plate			
Condenser / evaporator	Fiber tube / fiber tube			
Temperature controller	Computer control system			
Refrigerant	R600a 90g	R600a 90g	R404a 220g	R404a 200g
Weight	88kg	88kg	88kg	
Temperature range	-10℃~-25℃	-10℃~-25℃	-10℃~-40℃	
Rated power supply	220-240V~/50Hz	220-240V~/50Hz	220-240V~/50/60Hz	115V~/60Hz
Rated power / current	90W/0.7A	90W/0.7A	400W/4.8A	600W/7.5A
Noise Level	34dB(A)	34dB(A)	44dB(A)	
Foaming Agent	CP/IP			
Climate Type	4			
Electrical protection type	I			
Power supply connection	Y			
Testing hole	1			
Alarm	High/low temperature alarm, sensor fault alarm			

Note: under the ambient temperature of 25°C, the minimum temperature inside the empty equipment of the product of DW-40L series could achieve -40°C; and under the ambient temperature of 32°C, the minimum temperature inside the empty equipment could achieve -35°C.

Climate Type 4 means the temperature is +30°C, the relative humidity is 55%.

Technical information may vary from the appliance that you have just purchased due to technical improvements.

【Components and Function Modules】

1. Temperature control

It is controlled by microcomputer with digital display for temperature while the inner temperature can be adjusted from $-10^{\circ}\text{C} \sim -25^{\circ}\text{C}/-40^{\circ}\text{C}$; there is parameter setting for super low temperature alarming and break down memory.

2. Safety system

2 error alarming (high/low temperature alarming, sensor error alarming)

2 alarming methods (sound buzzing alarming, red light alarming)

Starting up delay protection function

3. Refrigerating system

Imported famous brand SECOP/DANFOSS compressor is adopted

Environment protection free refrigerant

German famous brand EBM fan

High density insulation layer with heat preservation

The evaporimeter is used as rack directly for speed refrigeration.

4. Humanity design

Drawer design for convenient utilization

LED digital temperature display for convenient observation

Broad voltage belt suitable for voltage

Doorknob design for easy on and off

Trundle design for convenient motion

Gate locks design for safe storage

5. Product graphical representation



Remark:

- For DW-25L92 Series or DW-40L92 Series, please take out the suite of lock catch from the accessory and install the lock catch on the left side of the box according to "Lock Catch Installation Instruction leaflet"
- The press is located in the cabin on rear bottom of the refrigerator with cabin cover
- The condenser is located at rear of the refrigerator.
- The evaporimeter is located inside the refrigerator as rack

【Disassemble Steps】

1. Install the Handle

- ① .Align the handle to the screw hole on the door;
- ② .Use screw to fix the handle.

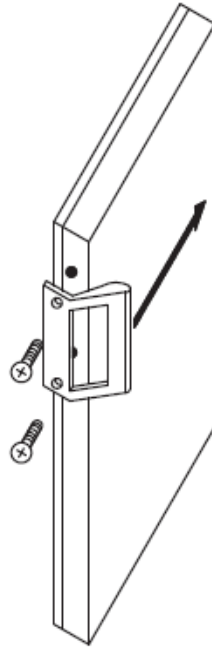

2. Disassemble steps for control board

- Unscrew the following screws marked 1 and 2 in following figure, the control board can be fetched.



- Attention: there are wires connecting control panel and refrigerator as shown in following:



- The following is details for connection of computer board and ports;

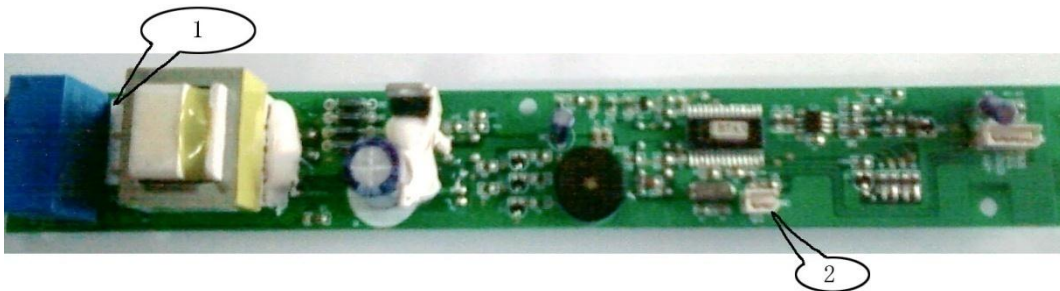

- Mark "1" in the above figure is connecting port for power line to connect power line; mark "2" in the above figure is sensor port to connect sensor line.

3. Installation steps for control board

- Installation shall be according to 2-4 disassembly steps oppositively.

【Screen Control System】

1 External view of computer board



2 Basic parameters for computer board

- Rated power 3W
- Control current for press under normal operation shall be no more than 10A
- The 30 seconds start delay for the first energization of press . In normal operation, each time it is shut down, start timing, the compressor will not start if the start up time is less than 5 minutes; if the time is over 5 minutes, please take the actual time for operation.

3 Temperature display function

- The actual temperature displayed is integer. The measured value is rounded off to integer. in normal situation, the temperature shall not hop, with all temperature variable being $\pm 1^{\circ}\text{C}/\text{min}$;
- The display range is from $+34^{\circ}\text{C}$ to -45°C , with temperature higher than $+34^{\circ}\text{C}$, displaying "HH"; with temperature lower than -45°C , displaying "LL".

4 Quick-freeze setup function

- Press quick-freeze button to light indicating light SF, indicating that the refrigerator is in operation; press the button again to release the status, or it may be released automatically after three hours. Temperature can not be set under quick-freezing status;

5 Overheat alarming function

- When the actual temperature sensed by the sensor is higher $+5^{\circ}\text{C}$ higher or lower than set temperature, the overheat alarming light will flicker (with interval of 1S), accompanies by buzzing (with interval of 0.5S). Press the buzzing releasing button to release buzzing; but the red light will keep on flickering (press again can not recover buzzing. It is only when the temperature is within $+5^{\circ}\text{C}$ upper or lower than set temperature or cut the power, the buzzing releasing button can reset to recover buzzing function).
- Note: if the freezing sensor is in error, the red light may keep on flickering with interval of 1S and alarming fail.

6 Recovery processing and error display of freezing sensor

- When the freezing sensor is in error (short circuit or open circuit), the temperature value displayed will be "F1"; the frozen food cabinet enters protecting mode and compressor is in fixed alternation of 20min on and 5min off with alarming in failure; if the refrigerator is in quick-freeze status, quit (the corresponding light will be off).

7 Break down memory function

- When the frozen food cabinet is broken down and electrified again, the memory function can operate according to status set before breaking down.
- Display control>quick freeze>normal control F1 display >temperature display

8 Temperature adjustment principle and alignment

This machine adopts microcomputer controlled temperature control system to control on-off of the press. In electrified condition, the screen may display current temperature. If you want to change the set temperature, for example, change from -30°C to -35°C , please operate as following:

Press both “ \wedge ” and “ \vee ” for 3 seconds, the set temperature starts flickering. Press “ \wedge ” once, the temperature will decrease by 1°C until it reaches -40°C , and then press back to -10°C ; press “ \vee ” once, the temperature will increase by 1°C until it reaches -10°C , and then press back to -40°C ; if there is no 5 second operation, quit the setting status back the normal temperature display.

Press “quick-freeze”, “ Δ ” and “ ∇ ” simultaneously for 5 seconds to align difference between displayed temperature and set temperature at certain point, with aligning temperature being $\pm 5^{\circ}\text{C}$. If the displayed temperature is -40°C and temperature of certain point is -35°C , enter $+5^{\circ}\text{C}$ to make display temperature -35°C , vice versa.

Press alarm, cancel and temperature set for 10 seconds, the screen display HS. Press two temperature setting buttons simultaneously, the number on screen flickers; press “ Δ ” and “ ∇ ” to set highest temperature and then loosen. It will quit automatically in 3 seconds and the screen now displays LS. Press two temperature setting buttons simultaneously, the number on screen flickers; press “ Δ ” and “ ∇ ” to set lowest temperature and then loosen. It will quit automatically in 3 seconds.

Note: a. temperature range for HS and LS is $10\sim 42^{\circ}\text{C}$ 。

b. When setting temperature for HS and LS, the HS value shall be higher or equal to LS, or it can not be set.

c. Once the HS and LS are set, press both temperature setting buttons simultaneously. The set temperature shall be set within HS and LS (including) only.

d. When both HS and LS are set -25 , the set temperature shall be -25°C . Set temperature can not be adjusted and the quick freeze function fails.

【Control System Principle】

1 Working principle for press on and off

When inner temperature reaches set temperature, induct the temperature by sensor and change into electrical signal which is sent to control chip of computer board. By pre-set procedure, the chip then sends out stop order to compressor to shut it down. When the inner temperature is returned 1 °C higher than set temperature, the chip sends out stop order via the same procedure to shut the compressor down. (If temperature return in the refrigerator is too fast, less than 5 minutes, then take it as 5 minutes.)

2 Working principle for fan on and off

The fan is in synchronous operation with the compressor. Please refer to 6-1 press working principle for fan working principle.

【 System Schematic Diagram 】

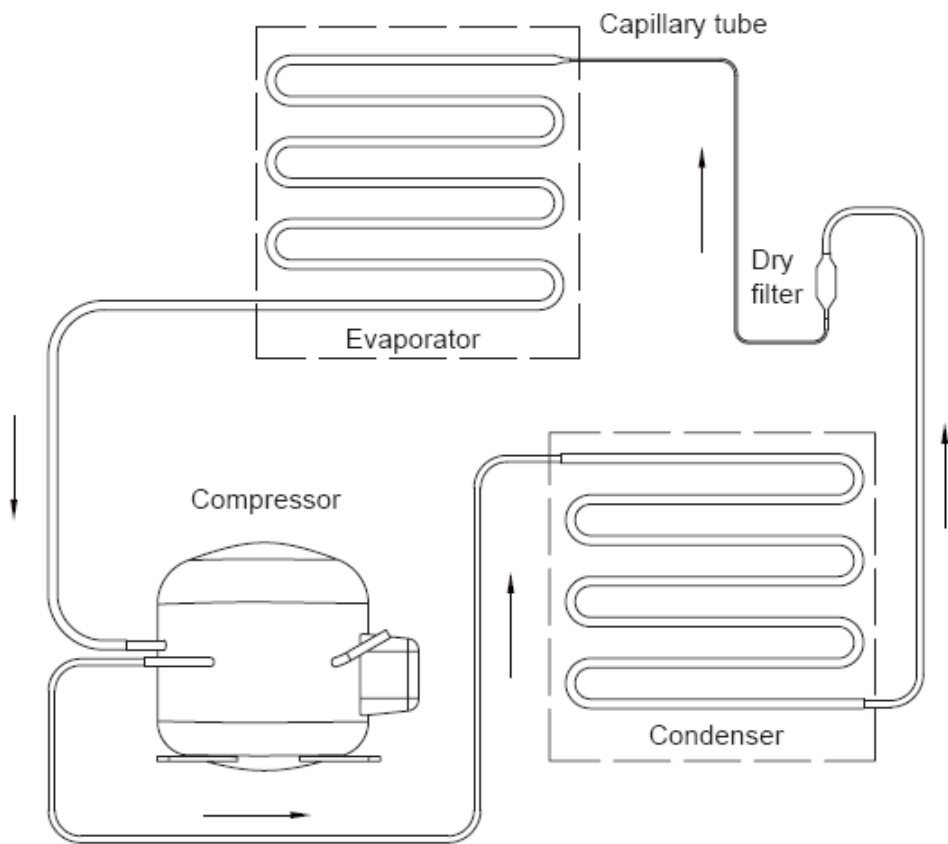

【System Circuit Diagram】

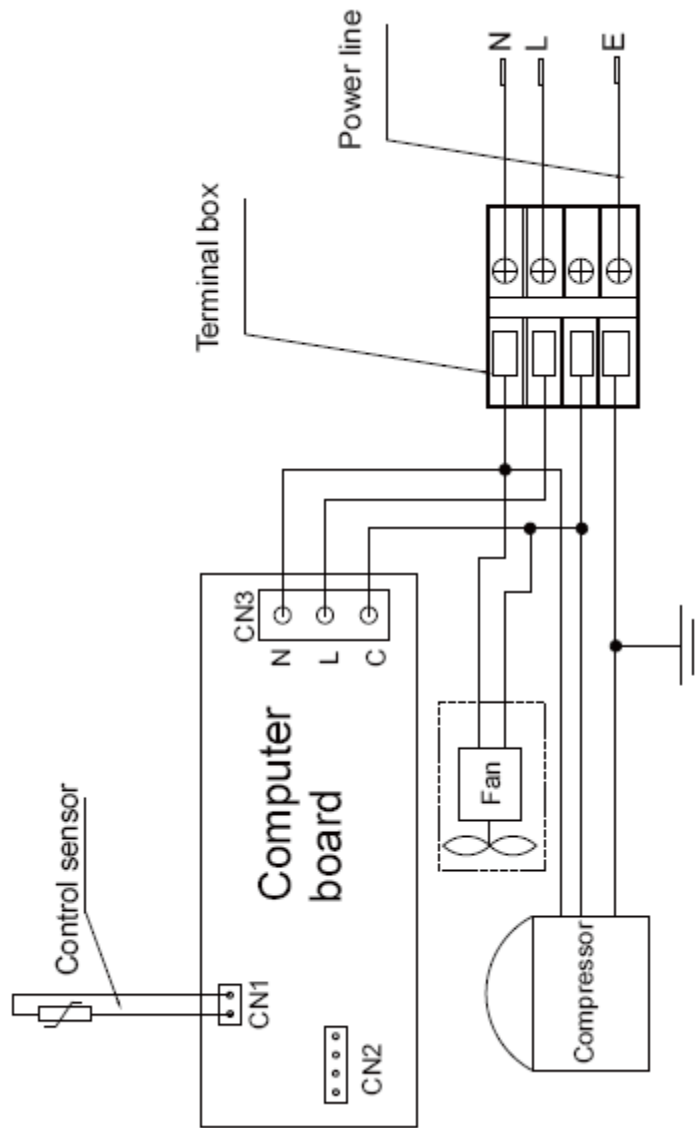

Note: DW-25L series of products are not equipped with the fan in the frame with dotted lines.

【Inspection and Maintenance Process for Typical Error】

Problem points		Reason analysis	Maintenance measures
1. the press can not start		1. The fuse is burned out.	Change the fuse
		2. Connecting parts of cabinet is damaged.	Change socket connector.
		3. The connecting line for electric cabinet is not in right position.	Install correctly after inspection.
		4. The temperature controller is in error.	Adjust parameters. If the temperature controller is damaged, change it.
		5. The starter or thermal protector is damaged.	Change the starter or thermal protector.
		6. The press is in error.	Change press.
2. High temperature inside the refrigerator		1. The set temperature is high.	Reset
		2. The freezing agent is leaking.	Find leaking point and weld. Refill freezing agent.
		3. The temperature controller is damaged.	Change the temperature controller.
		4. The capillary or system is dirt and stopped.	Clean capillary or change filter.
3. The screen doesn't display temperature.	It displays F1.	1. The temperature-sensing probe is in short or open circuit.	Inspect the temperature sensing probe.
		2. Without temperature sensing probe.	Install temperature sensing probe.
4. Big noise		1. The refrigerator is not even.	Change position of the refrigerator.
		2. Sympathetic vibration between pipelines or refrigerators when press operating.	Clear up the pipelines to avoid sympathetic vibration.
		3. Fan and fan bracket is loosen.	Re-fix
		3. Connection bolts of the press is loosened.	Tight the inner connecting bolts.

【FAQ&A】

Question	Answers	Measures able to adopt
1. Inner temperature is too high or too low.	Can be resolved by adjusting and control of temperature.	See detailed operation in instruction manual.
2. Sides of the refrigerator is hot.	There is anticoagulant near refrigerator open on side surface. Heating is normal instead an error.	Can turn off the electric heating switch.
3. There is difference between displayed temperature and detected temperature.	The displayed temperature is temperature on sensing probe. It is normal to has difference with that of the refrigerator.	Normal situation needs no resolution.
4. The alarming rings in short time after start up.	Alarm when the inner temperature in within alarming region.	Normal situation needs no resolution.

Why there is serious frosting in DW-25/40L series?

Answer: it may caused by loosen door or frequent opening the door, or one of the small hole allowing condenser to enter the refrigerator is not plugged up. This needs to be disposed by service persons. Moreover, regular defrosting is required to keep better effect, normally once per 1-2 months.

Error of DW-25/40L series sensors and how does press operate?

Answer: During the operation of DW-40L low temperature reserving box, when the freezing sensor is in error (short circuit or open circuit), the temperature value displayed will be "F1"; the frozen food cabinet enters protecting mode and compressor is in fixed alternation of 20min on and 5min off with alarming in failure; if the refrigerator is in quick-freeze status, quit (the corresponding light will be off).

What is the temperature setting range for DW-25/40L series machine?

Answer: the set range is -10~-25/-40℃.

【Cooling unit parts】

Part description	parameter	
	Models	Parameter
compressor	DW-40L92/188	Secop/Danfoss NL7CLX
power		220-240V/50Hz
Start capacitance		117U5015 (80uF)
compressor	DW-40L262	Secop/Danfoss SC12CL
power		220-240V/50Hz
Start capacitance		117U5017 (80uF)
compressor	DW-40L262	Secop/Danfoss SC12CLX.2
power		220-240V/50Hz/60Hz
Start capacitance		117U5019 (80uF)
compressor	DW-40L262	Secop/Danfoss SC12CLX.2
power		115/60Hz
Start capacitance		117U5023 (240 μ F)
compressor	DW-25L92/300	jiaxipera ZBC1115CY
power		220-240V/50HzHz
Start capacitance		TY-QZ-108
Refrigerant	DW-40L	R404a
Refrigerant	DW-25L	R600a
Fan motor	DW-40L	EBM AC230V/50/60Hz, 29/5W,1300rpm
Display panel	DW-25/40L92/188	0070809344 , Haier PCB
Display panel	DW-25/40L262/300	0070809343 , Haier PCB

【product nameplate】





Haier			
Deep Freezer			
Model:	DW-25L92	Refrigerant:	R600a: 52g
Inner Temperature:	-10℃ - -25℃	Anti-shock Safety Classification:	I
Effective Volume:	92L	Power Connection Type:	Y
Rate Voltage:	220-240V~	Foaming Cabinet:	CP/IP
Rate Frequency:	50Hz	Manufacture Date and No.:	in the Barcode
Power Input	77W		
Rate Current:	0.35A		
Climate Class:	4		
Weight:	46kg		
Haier Medical and Laboratory Products Co.,Ltd. Haier Industrial Park,Economic Technology Development Zone, Qingdao 266510.P.R.China			

Haier				CE 0197	
Deep Freezer					
Model:	DW-40L92	Refrigerant:	R404a: 150g		
Inner Temperature:	-10℃ - -40℃	Anti-shock Safety Classification:	I		
Effective Volume:	92L	Power Connection Type:	Y		
Rate Voltage:	220-240V~	Foaming Cabinet:	CP/IP		
Rate Frequency:	50Hz	Manufacture Date and No.:	in the Barcode		
Power Input	180W				
Rate Current:	0.5A				
Climate Class:	4				
Weight:	46kg				
					
Haier Medical and Laboratory Products Co.,Ltd. Haier Industrial Park,Economic Technology Development Zone, Qingdao 266510.P.R.China					

Haier

Deep Freezer



Model:	DW-40L262	Refrigerant:	R404a: 220g
Inner Temperature:	-10°C - -40°C	Anti-shock Safety Classification:	I
Effective Volume:	262L	Power Connection Type:	Y
Rate Voltage:	220-240V~	Foaming Cabinet:	CP/IP
Rate Frequency:	50/60Hz	Manufacture Date and No.:	in the Barcode
Power Input	400W		
Rate Current:	4.8 A		
Climate Class:	4		
Weight:	88kg	    	



Haier Medical and Laboratory Products Co.,Ltd.

Haier Industrial Park,Economic Technology Development Zone, Qingdao 266510.P.R.China

Haier

Deep Freezer

Model:	DW-40L262	Refrigerant:	R404a: 200g
Inner Temperature:	-10°C - -40°C	Anti-shock Safety Classification:	I
Effective Volume:	262L	Power Connection Type:	Y
Rate Voltage:	115V~	Foaming Cabinet:	CP/IP
Rate Frequency:	60Hz	Manufacture Date and No.:	in the Barcode
Power Input	600W		
Rate Current:	7.5 A		
Climate Class:	4		
Weight:	88kg		

Haier Medical and Laboratory Products Co.,Ltd.

Haier Industrial Park,Economic Technology Development Zone, Qingdao 266510.P.R.China

Haier

Deep Freezer

Model:	DW-25L300	Refrigerant:	R600a: 90g
Inner Temperature:	-10°C - -25°C	Anti-shock Safety Classification:	I
Effective Volume:	300L	Power Connection Type:	Y
Rate Voltage:	220-240V~	Foaming Cabinet:	CP/IP
Rate Frequency:	50Hz	Manufacture Date and No.:	in the Barcode
Power Input	90W		
Rate Current:	0.7A		
Climate Class:	4		
Weight:	88kg		

Haier Medical and Laboratory Products Co.,Ltd.

Haier Industrial Park,Economic Technology Development Zone, Qingdao 266510.P.R.China

【Refrigerant perfusion Details】

Type	DW-40L92	DW-40L188	DW-40L262 (220-240V/50 Hz /60Hz)	DW-40L262 (115V/60Hz)	DW-25L92	DW-25L300
R404a	150	210	220	200		
R600a					52	90

[Note] refrigerant type and weight of the nameplate subject shall not misuse of refrigerant.

【 Troubleshooting 】

Fault	Analysis	Maintenance Measures
1. compressor fails to start	1. Machine storehouse wiring connector plugs s are damaged	Change the connector plugs
	2. Bas wire contact	Check contact and make in good condition.
	3. Display panel connection failure	Checking if it is due to bad connection, otherwise, change it.
	4. Relay, start capacitor or heat protector is damaged	Change the part.
	5. Compressor fault	Change the compressor
	6. User's voltage is too low	Add a manostat
2.Fan does not rotate	1. Fan wiring is loose	Checking the wiring
	2. Fan blades are blocked by foreign matters	Checking and clean them
	3. Fan is damaged	Change parts
3.High temperature in cabinet	1. The temperature setting of outage is too high.	Re-set computer board
	2. Refrigerant leaks.	Find leak location and make repair welding. Infuse refrigerant again.
	3.Temperature probe is damaged	Change parts
	4. Capillary tube or system is blocked by dirt\ greasy	Clean the capillary tube or change filter.
	5. High ambient temperature	Turn on air-conditioner, reduce ambient temperature.
	6. Condenser blockage	Clean condenser
4.Display board displays F1	1. Temperature probe short circuit or disconnect	Checking the temperature probe
	2.No temperature probe	Install a temperature probe

【How to deal with poor cooling】

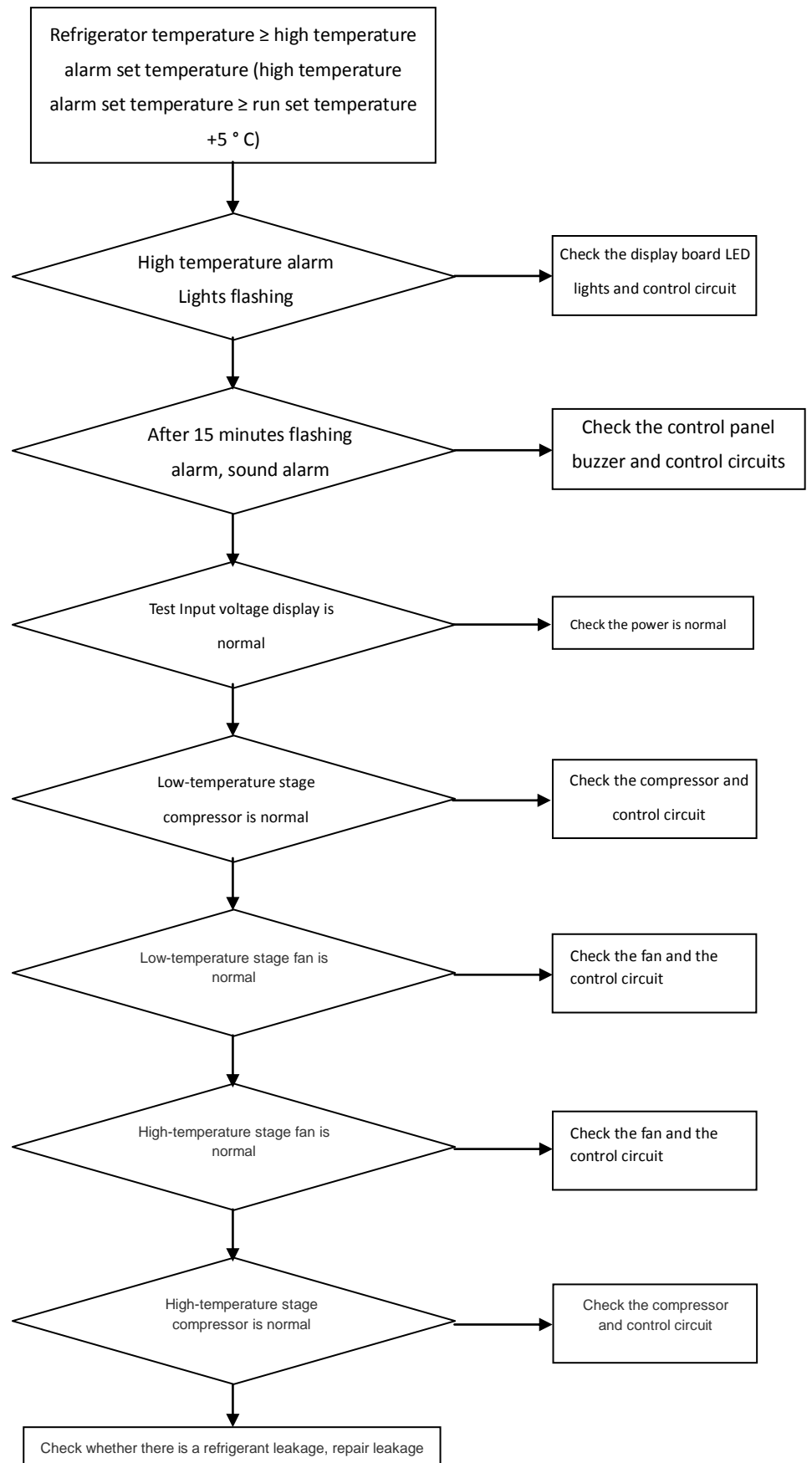

【Used Spare Parts Photo Gallery】

DW-25/40L262/300 Exploded view

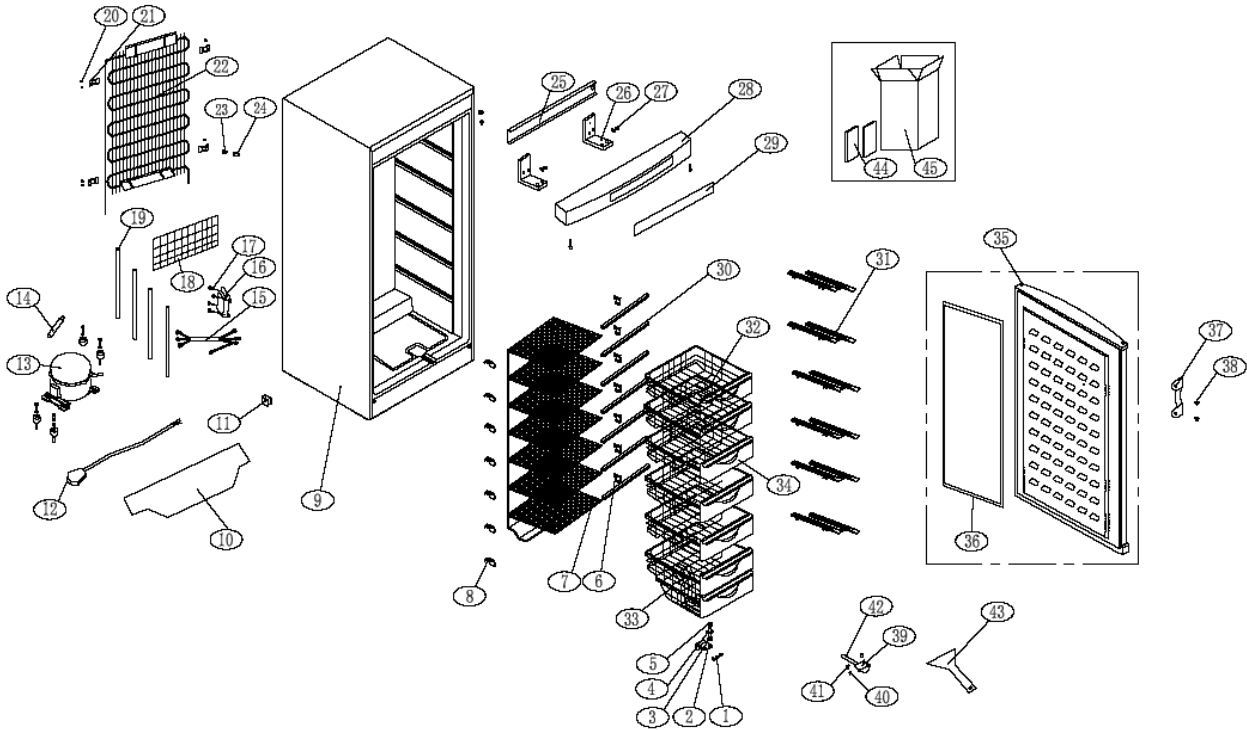

DW-25/40L262/300 spare part list

No.	Code	Name	Qty	
1	0060802007	Screw 15M6*16	3	
2	0060100278	Seat of lower hinge Q215-A5mm	1	
3	0064240002	Washer 65Mn	1	
4	0067113077	Rotation shaft 15	1	
5	0067744009	Washer PA white	1	
6	0060201602	Right limit block PP	7	
7	0070809547	DW-40L262 evaporator	1	
8	0060201601	Left limit block PP	7	
9	0060809575	Main foaming cabinet	1	
10	0070104307	Fix board of compressor	1	
11	0072130028	clips	2	
12	0070400325D	EURO power cable	1	
	0270400113	British three pin power cable	1	
	0070401590A	British three column power cable	1	
	0070402229	American power cable1	1	220-240V/50Hz/60Hz
	0070402228	American power cable2		115V/60Hz
13	0060700668	Compressor ZBC1115CY	1	DW-25L

	0075010051	Compressor SC12CL(220-240V/50Hz)		DW-40L
	0274000190	Compressor SC12CLX.2(220-240V/50Hz/60Hz)	1	DW-40L
	0074091173	Compressor SC12CLX.2(115/60Hz)	1	DW-40L
14	0070701909	DW-40L262 drier filter	1	
15	0070401698	Compressor wire	1	
16	0072040045	Wire connection box	1	
17	0077050051	Screw	4	
18	0070107165	Cover of cabin	1	
19	0073150003	ROHS-sealing tube (black) 490MM	4	
20	0077050051	Screw	8	
21	0067412381	built-in fitting parts PP	4	
22	0060502027	Condenser	1	
23	0067266077	ROHS-pipe inner suit PVC	2	
24	0060211012	ROHS-sealing cover of Power cable	1	
25	00601330269	Support board	1	
26	0060812716	ROHS-upper hinge board	2	
27	0064082716	Screw	4	
28	0070809344	Display panel assy	1	
29	0070506514	Display film	1	
30	00601600103	Decorative strip of condensor	7	
31	0270200215	Washer of evaporator	12	
32	0270200562	Big door	6	
33	0270200563	Small door	1	
34	/	/	/	/
35	0270800221	Foaming door	1	
36	0070203433A	Door seal	1	
37	0070107470	DW-40L262 handle	1	
38	0077050001	Screw	2	
39	0067412230	ROHS-drain box	1	
40	0077050051	ROHS-screw	2	
41	0067412233	Screw hat PE	2	
42	0067412140	Drain pipe	1	
43	0060211896	Shaft of defrost	1	
44	0270500040	DW-40L262protect packing	2	
45	0270500395	packing	1	
46	0074091509	Condenser fan	1	DW-40L

DW-25/40L92exploded view

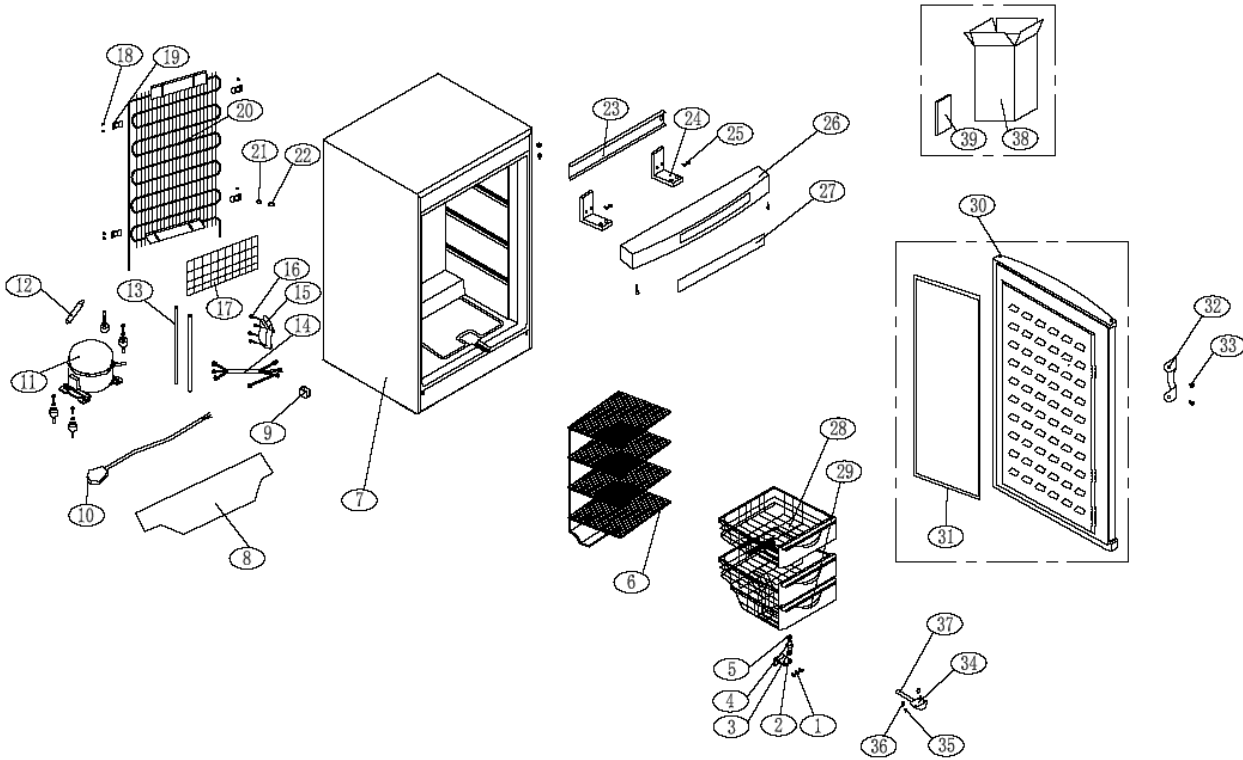

DW-25L92spare part list

No.	Code	Name	Qty	
1	0060802007	Screw 15M6*16	3	
2	00609380634	Seat of lower hinge	1	
3	0064240002	Washer 65Mn	1	
4	0067113077	Rotation shaft 15	2	
5	0067744009	Washer of hinge	2	
6	0270700332	Evaporator	1	
7	0060809635	Foaming cabinet	1	
8	0070104306	Fix board of compressor	1	
9	0072130028	clips	2	
10	0060611001	Power cable cn	1	
	0070400325D	Euro power cable	1	
	0270400113	British 3-pinpower cable	1	
11	0060700668	Compressor ZBC1115CY	1	DW-25L
	0074000149	Compressor NL7CLX	1	DW-40L
	0075010051	Compressor SC12CL	1	DW-40L
12	0070701909	DW-40L262drier filter	1	
13	0073150003	Seal pipe (black) 490MM	2	

14	0070401698	DW-40L188 compressor wire RVV3 ×0.75	1	
15	0072040045	Wire connect box	1	
16	0077050051	Screw	4	
17	0070107165	Cover of cabin	1	
18	0060801078	Screw 15B3.5*9.5	8	
19	0067412381	Built-in fitting of condenser PP	4	
20	00605020261	Condenser	1	
21	0067266077	Inner pipe suit PVC	2	
22	0060211012	Seal of power cable	1	
23	0060106846	Support board	1	
24	0060812716	Upper hinge 188/368	2	
25	0064082716	Screw	6	
26	0070809343	DW-40L188 display panel	1	
27	0070506515	Display film	1	
28	0060211132	Drawer I	2	
29	0060212152	Drawer II	1	
30	0070810979	Foaming door	1	
31	0270200177	Door seal	1	
32	00601600095	DW-40L262 handle	1	
33	0077050001	Screw	2	
34	0067412230	ROHS-drain box	1	
35	0077050051	ROHS-screw	2	
36	0067412233	Screw hat PE	2	
37	0067412140	Drain pipe	1	
38	0070504995	DW-40L262protect packing	1	
39	0060219168	packing	1	
40	0074091509	Condenser fan	1	DW-40L

Haier

Inspired living

Haier Medical & Laboratory Products Co., Ltd.

Room 403D, Brand Building, Haier Industrial Park, No.1 Haier Road

Qingdao China

Website: www.haiermedical.com